









This manual is applicable only to L100DB Temporiti brakes. For further information visit the website www.temporiti.it or contact the technical office.

1- Symbols

Symbol	Meaning	Description
	DANGER!	Danger of personal damage caused by a general source of danger It refers to an imminent danger that could give place to serious personal damage or death if the correspondent measures of protection are not respected.
	RISK OF ELECTROCUTION!	Danger of personal damage caused by high electrical voltage It refers to an imminent danger that could give place to serious personal damage or death if the correspondent measures of protection are not respected.
	STOP!	Danger of property damage It refers to an imminent danger the could give place to property damage, if the correspondent measures of protection are not respected.
	NOTE!	Important note to ensure troublefree operation
	TIP!	Useful tip for simple handling

2- General Alerts

	THE BRAKE IS DESIGNED TO GUARANTEE, WHILE RESTING AND THROUGH THE BRAKING TORQUE SPRINGS, THE INTRINSEC SAFENESS EQUAL TO ITS Nm PLATE VALUE	The brake function of the brake is to stop rotational movement of a shaft, according to the operating specifics on the site www.temporiti.it . The use of appropriate safety devices is left to the machine manufacturer (partly completed machinery).
	FEEDING VOLTAGE	The brake feeding voltage may vary of a $\pm 10\%$ in observance to the nominal tension signed on the label. The electromagnet requires a tension near the nominal value: an insufficient tension may cause a general bad working of the brake.
	ROOM TEMPERATURE	The room temperature for the brake correct working is between 5°C and 40°C. Call technical office for different or further requirements.

3- Toolbox

To follow without troubles the following manual, you need the following tools:



Allen key set



Dynamometrical key



USE STANDARD KEYS

Use standard keys only, without the help of extensions to have a correct bolts and nuts tightening.

4- Static Torque Value

	L100DB
Nominal Static Torque [Nm]	100

5- Installation and Regulation



KEEP METICULOUSLY THE DIRECTIONS ON THE PRESENT MANUAL

Adjusting operations carried out without following the operations of this manual, lead to a bad brake working.



DISCONNECT THE BRAKE FROM POWER SUPPLY

Carry out the inspection, servicing and adjusting operations only after the brake electrical disconnection.



SURFACES CLEANING

Good plane and braking surfaces cleaning, by using de-greasers that do not leave oily wasters, is necessary for good brake performance

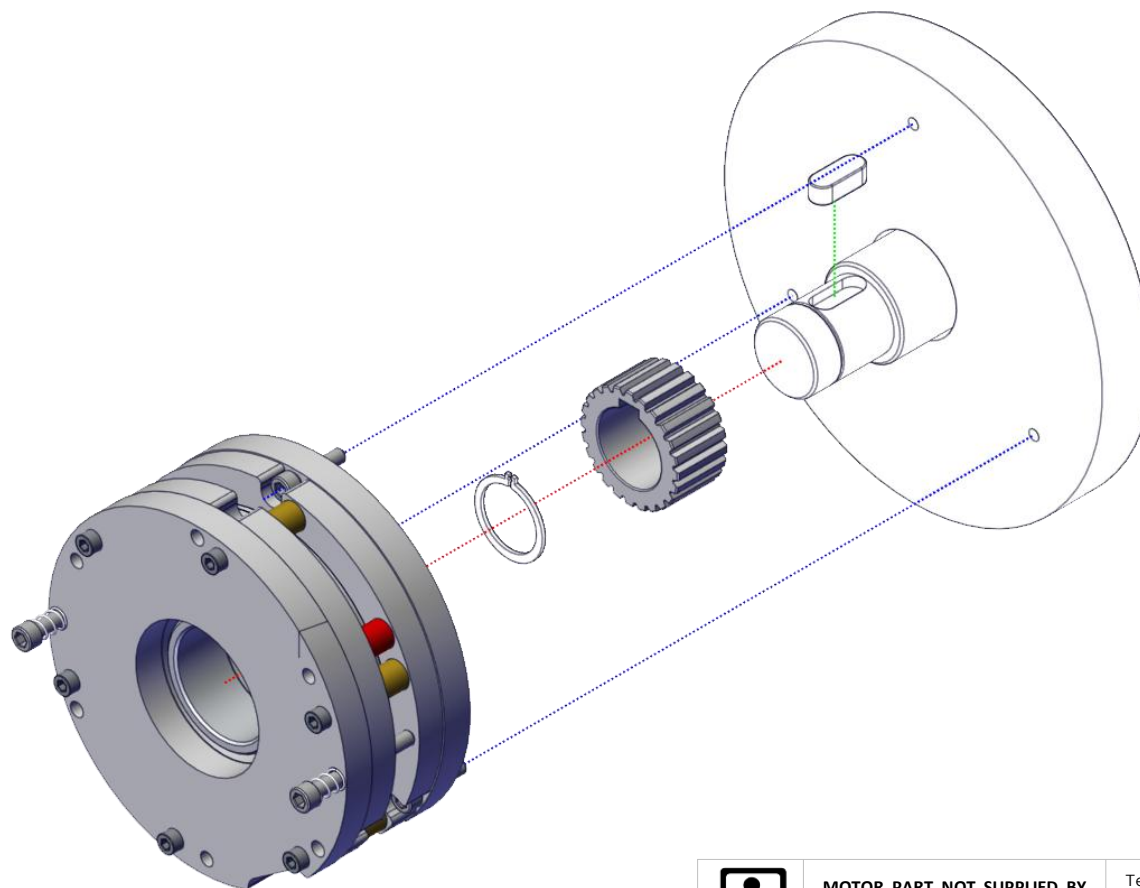

MOTOR PART NOT SUPPLIED BY TEMPORITI SRL

Temporiti srl does not supply motor parts as n-shield, shaft, fan cover, shaft key, hub seeger and sealing ring

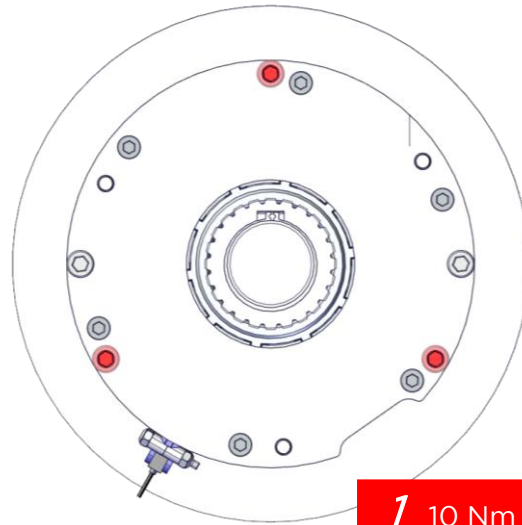
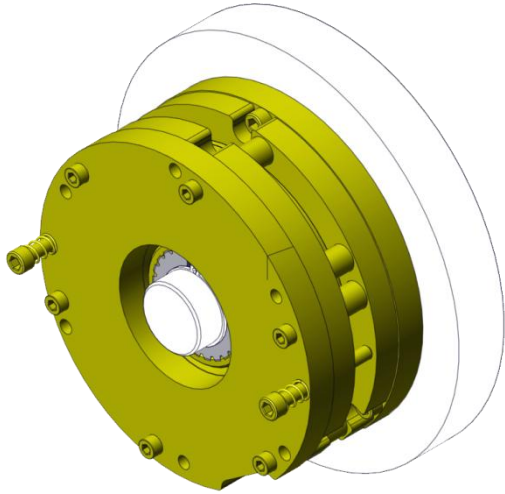
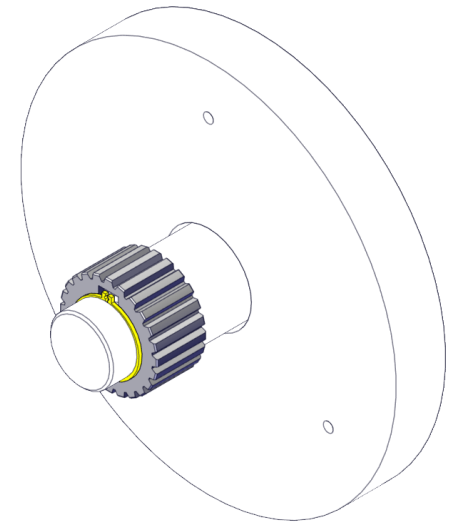
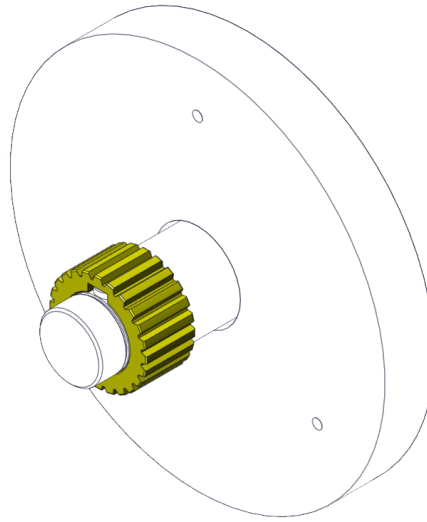
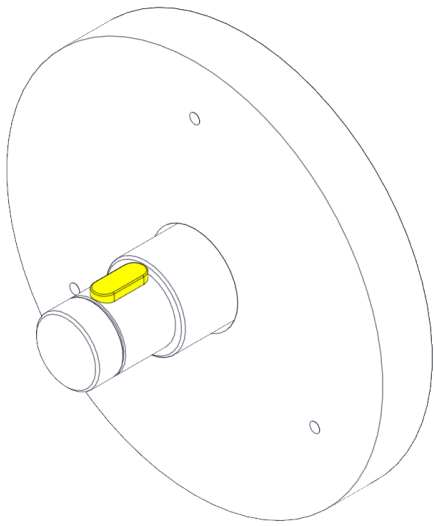

1 10 Nm

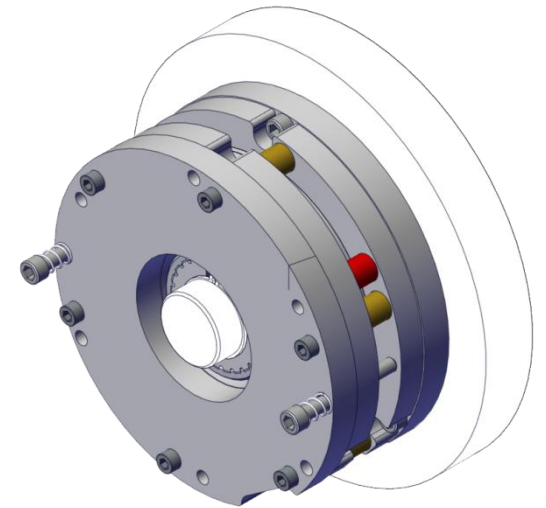

5.3- Electrical connection

Connect the brake to motor following the following schema

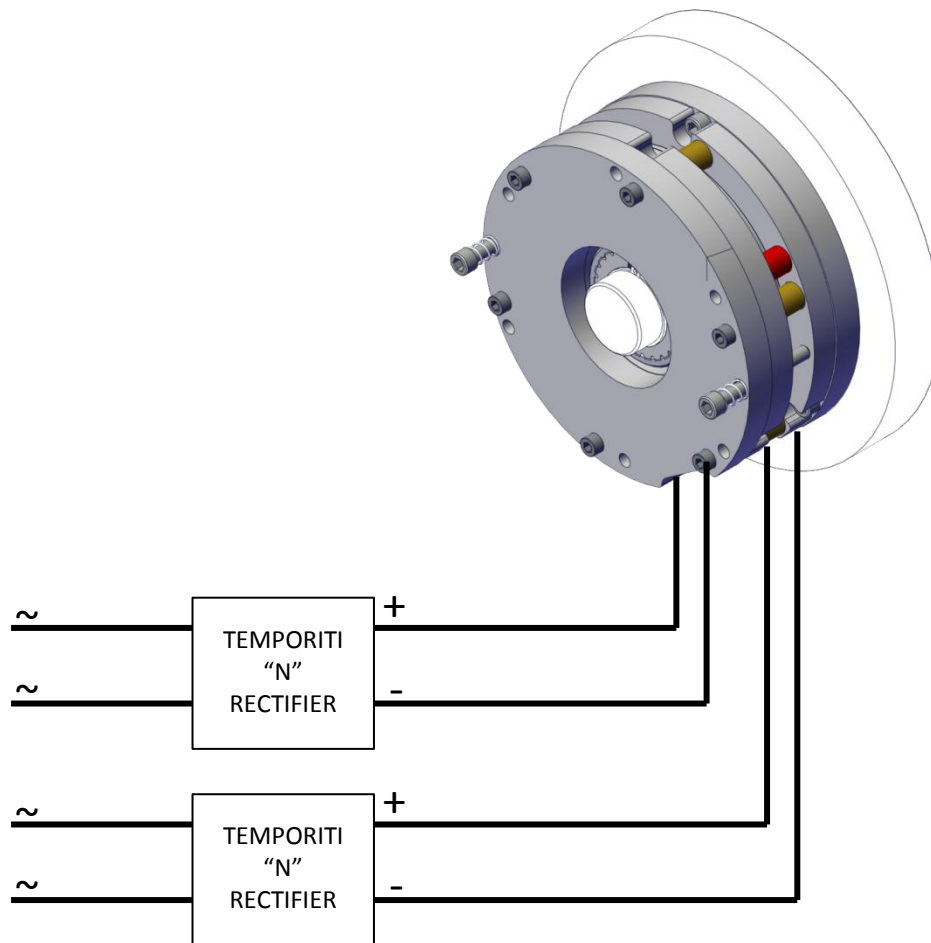

6- Servicing



A frequent brake inspection is necessary for all parts as the wear depends on a series of factors and mainly on the load inertia, the shaft speed and the operation frequency. Verify the main parts of the brake group and, in case, replace them with original spare parts supplied by Temporiti SRL.
Servicing may be roughly determined according to what is pointed out on the site.

6.1- Brake replacement

The brake must be replaced after a consumption of friction material ring, that is when the minimum total thickness value is reached.

Disc replacement thickness limit - B [mm]		
BRAKE SIZE	L100	
THICKNESS LIMIT [mm]	11.8	

6.2- Maintenance

	KEEP METICULOUSLY THE DIRECTIONS ON THE PRESENT MANUAL	Adjusting operations carried out without following the operations of this manual, lead to a bad brake working.
	DISCONNECT THE BRAKE FROM POWER SUPPLY	Carry out the inspection, servicing and adjusting operations only after the brake electrical disconnection.
	SURFACES CLEANING	Good plane and braking surfaces cleaning, by using de-greasers that do not leave oily wasters, is necessary for good brake performance

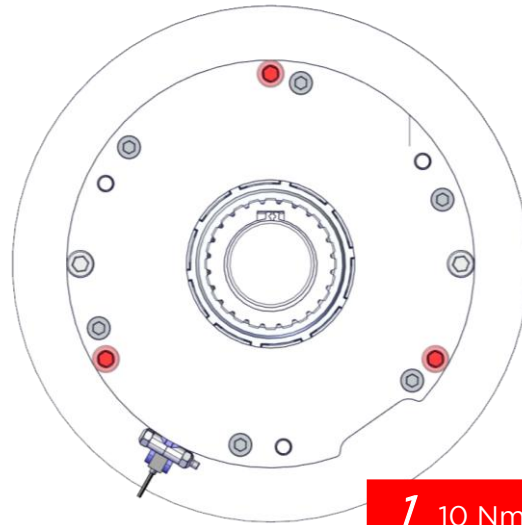
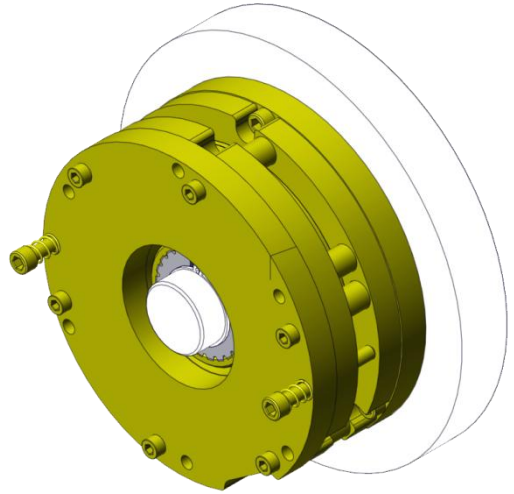
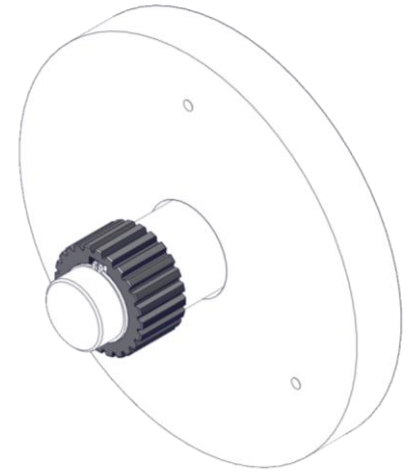
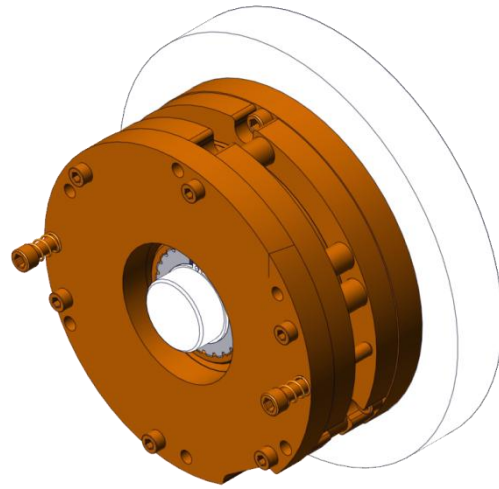
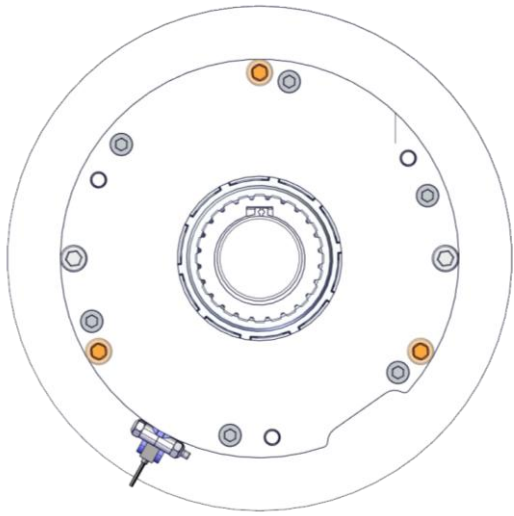

7 10 Nm

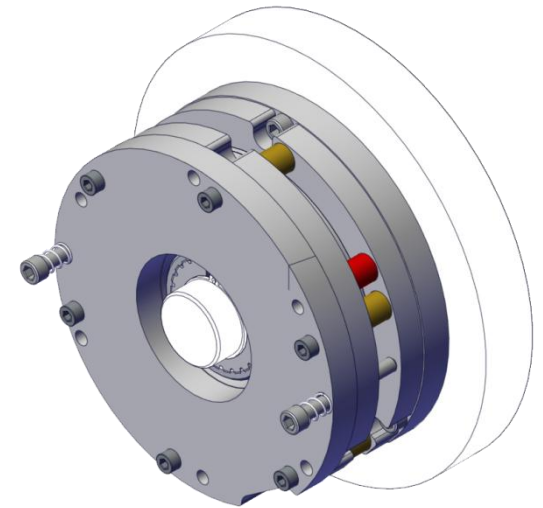

Use a new brake or a serviced one by Temporiti Srl

Remove

Install

Adjust

Measure

Torque

INSPECTION AND MAINTENANCE TIME	
INSPECTION THEORETICAL TIME	MAINTENANCE THEORETICAL TIME
5min for disc thickness checking with technician in front of the brake	15min for brake sostitution with technician in front of the brake

RISK HYPOTHESIS	
RISK	ACTION TO DO
No signal by microswitch	Contact Temporiti srl

7-Disposal and recycle information



Recycle in eco-friendly way the packaging, metals and all the parts of no longer working brakes.

DO NOT THROW USED ELECTROBRAKES, OR PARTS THEREOF IN THE HOUSEHOLD RUBBISH!

Dispose separately from household rubbish the friction material (asbestos-free) after removing it from the metal part of the disk with a proper tool. Remove the resin from the electromagnet with a proper tools and dispose of it in accordance with current law regulations. According the European Directive 2002/96/CE on waste electrical and electronic equipments (RAEE) and its implementation of national law, the electrical equipments no longer usable must be collected separately and must be sent to a recycling step

This document is applicable only to L150DB - L250DB - L320DB Temporiti brakes. For further information contact the technical office.

SYMBOLS AND MEANING		DESCRIPTION
	DANGER!	Danger of personal damage caused by a general source of danger It refers to an imminent danger that could give place to serious personal damage or death if the correspondent measures of protection are not respected.
	RISK OF ELECTROCUTION!	Danger of personal damage caused by high electrical voltage It refers to an imminent danger that could give place to serious personal damage or death if the correspondent measures of protection are not respected.
	STOP!	Danger of property damage It refers to an imminent danger the could give place to property damage if the correspondent measures of protection are not respected.
	NOTE!	Important note to ensure troublefree operation

	THE BRAKE IS PROJECTED TO GUARANTEE, WHILE RESTING AND THROUGH THE BREAKING TORQUE SPRINGS, THE INTRINSEC SAFENESS EQUAL TO ITS Nm LABEL VALUE.	The electromagnetic brake model "LIFT" is a spring applied, power continuous current brake. The function of the brake is to stop rotational movement of a shaft, according to the operating specifics on the site www.temporiti.it . The use of appropriate safety devices is left to the machine manufacturer (partly completed machinery).
	FEEDING VOLTAGE	The feeding voltage of the brake may vary of a $\pm 6\%$ in observance to the nominal tension signed on the label. The electromagnet requires a tension near the nominal value: an insufficient tension may cause a general bad working of the electro-brake.
	ROOM TEMPERATURE	The room temperature for the correct working of the brake is between 5°C and 40°C. Call the technical office for different or further requirements.
	HANDLING	Handling of the product must be carried out without compromising the position and integrity of each part of the brake
	MAINTENANCE	Maintenance must be performed by personnel qualified by Temporiti Srl or directly by Temporiti Srl

INSTALLATION

	KEEP METICULOUSLY TO THE DIRECTIONS ON THE PRESENT MANUAL	Adjusting operations carried-out without following the operations that follow lead to a bad working of the brake.
	DISCONNECT THE BRAKE FROM POWER SUPPLY	Carry-out the inspection, servicing and adjusting operations only after electrically disconnecting the brake.
	CLEANING OF THE SURFACES	Good cleaning of the braking surfaces and planes by using de-greasers that do not leave oily wastes, is necessary for a good performance of the brake.
	BRAKING SURFACE ROUGHNESS	The brake application braking surface roughness has to be $\leq 1,6\mu\text{m}$

						USE STANDARD KEYS ONLY WITHOUT THE HELP OF EXTENSIONS TO HAVE A CORRECT TIGHTENING OF THE BOLTS AND NUTS
Wrench (fork)	Allen key	Dynamometrical key	Thickness gauge	Multimeter		TOOLS DIMENSIONS ARE SHOWN IN THE PROCESS IMAGES OF THIS MANUAL

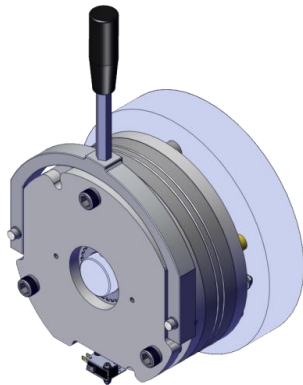

Descrizione	ID BOM	Qtà
BRAKE GROUP	1	1
FRICION DISC	2	2
HUB	3	1

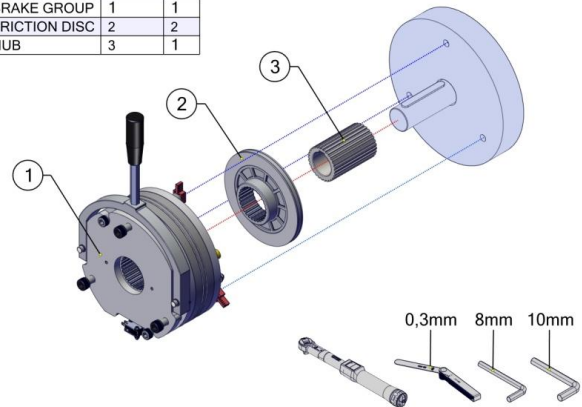

DO NOT FIX ANYTHING TO THE MAGNET AS NOT TO INTERFERE WITH ITS CORRECT WORKING

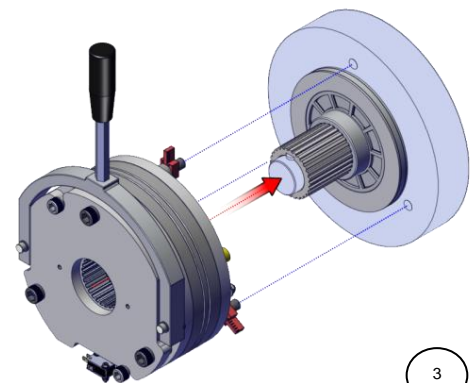
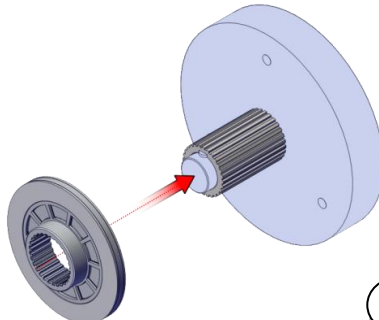
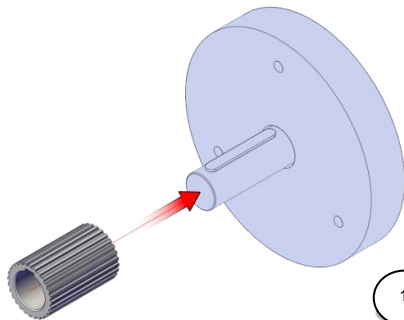

The transmission of the motion between shaft and hub must be made through key, following the brake drawing. The coupling has to be done with seeger or with hot coupling



If the shaft is toothed, the hub is not needed. Start from this point.

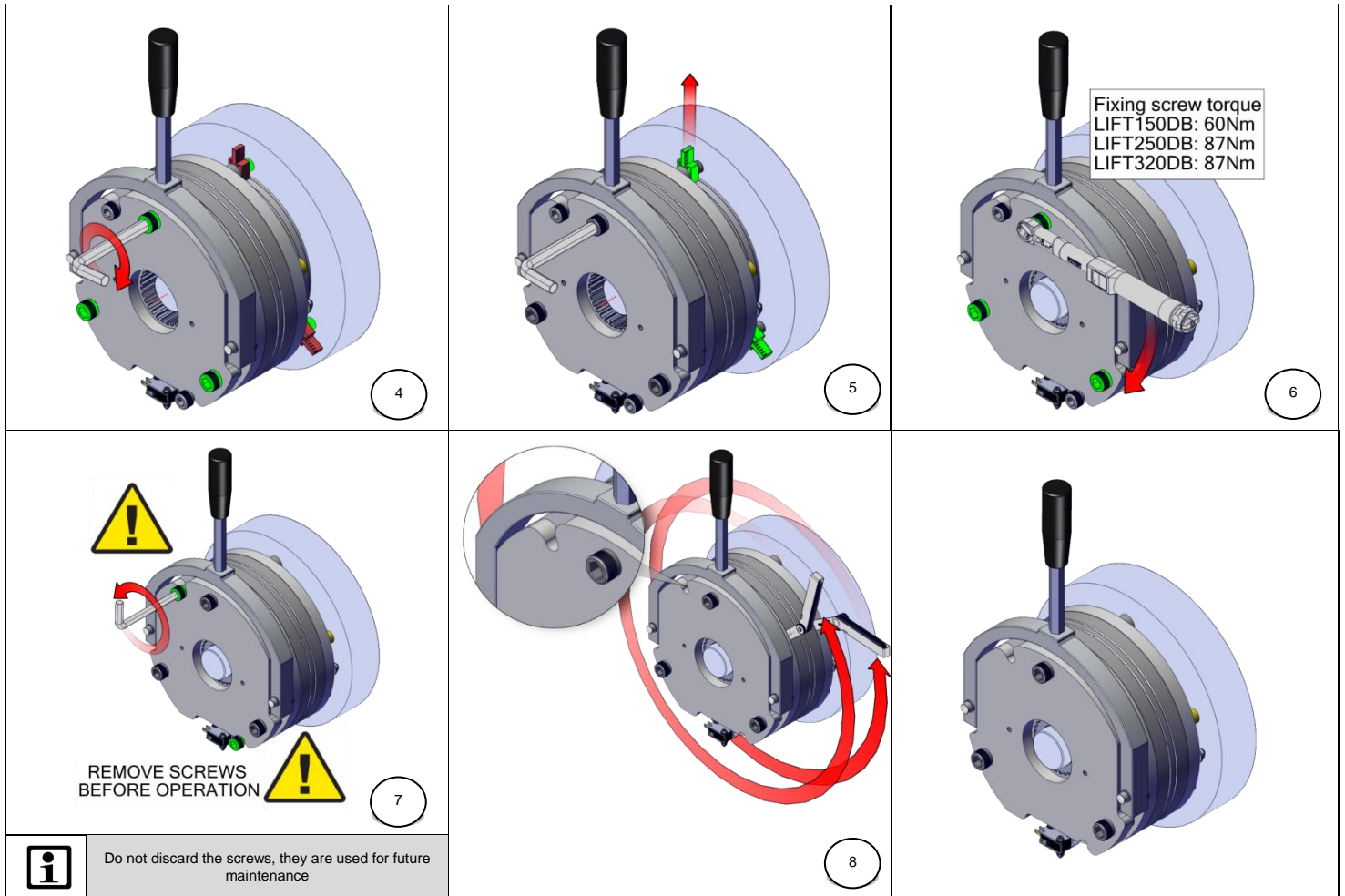

CONNECT THE BRAKE, FOLLOWING THE NEXT DIAGRAMS,

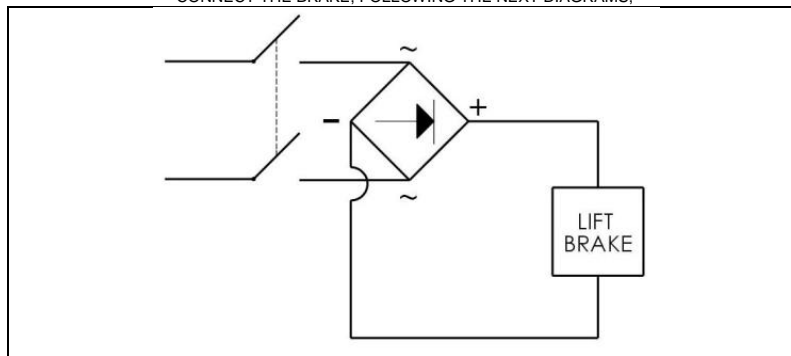

MANUAL HAND RELEASE

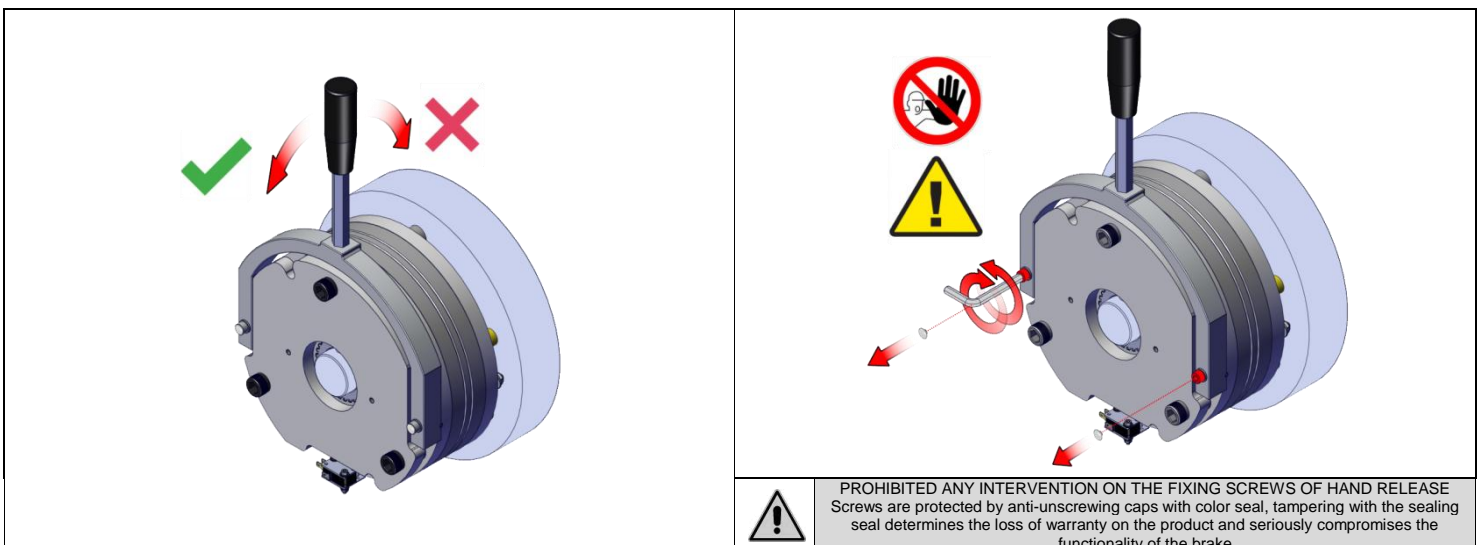

MAINTENANCE



FOLLOWING OPERATIONS MUST BE PERFORMED ONLY BY PERSONNEL QUALIFIED BY TEMPORITI SRL OR DIRECTLY BY TEMPORITI SRL

The following operations are guidelines for the qualified maintenance technician.

DISCS WEAR MAINTENANCE



Disc wear can affect the right brake functioning. During the system inspection is necessary check the brake discs status following the operation below

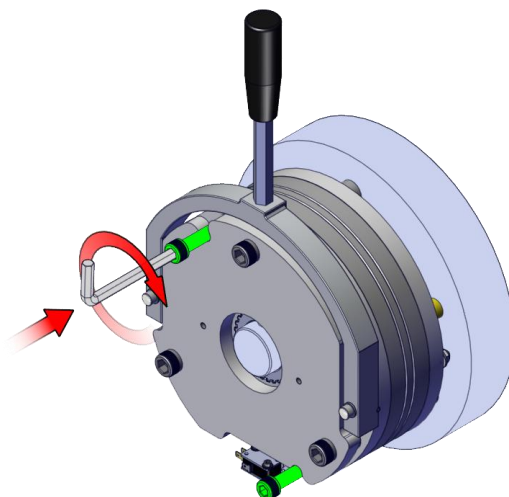
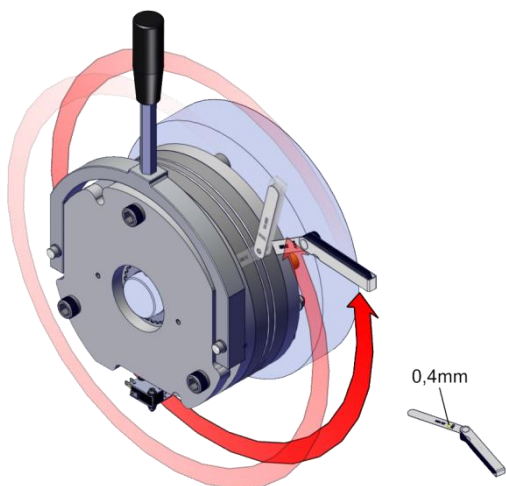

If 0,4 thickness gauge do not enter, is not necessary the discs maintenance



If this two screws are missing, you can use two M10x95 screws

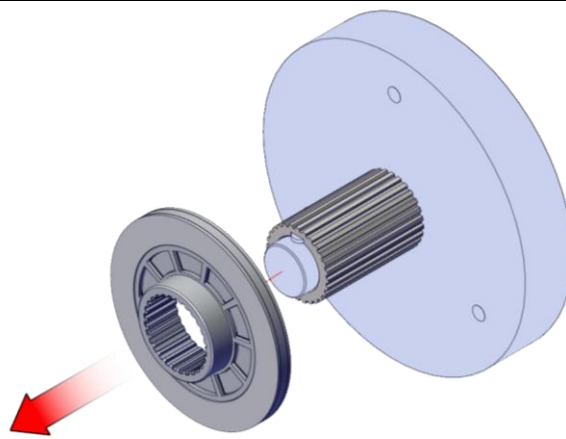
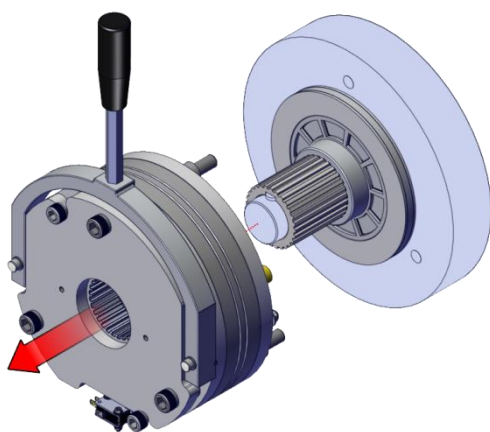
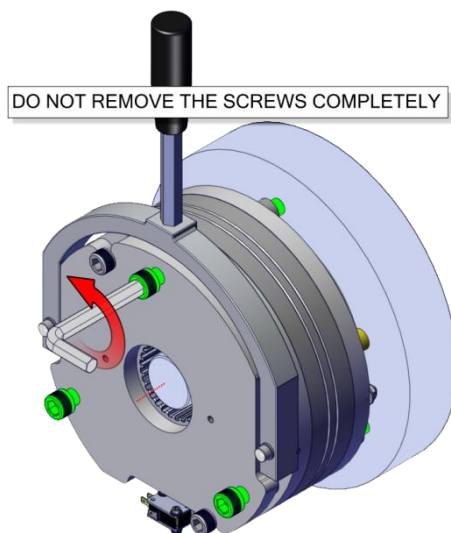
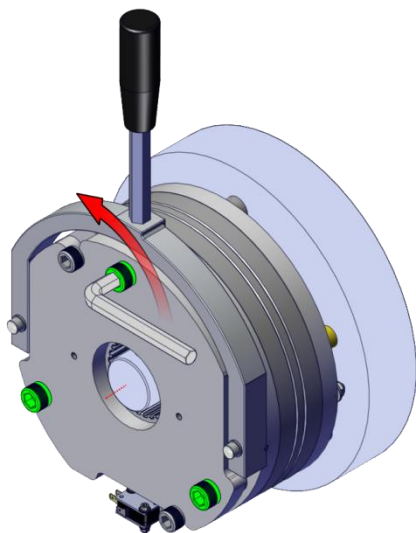

AFTER OPERATIONS ABOVE, FOLLOW THE INSTALLATION OPERATIONS BY POINT N°2 USING NEW DISC AND NEW BRAKE GROUP

MICROSWICH MAINTENANCE

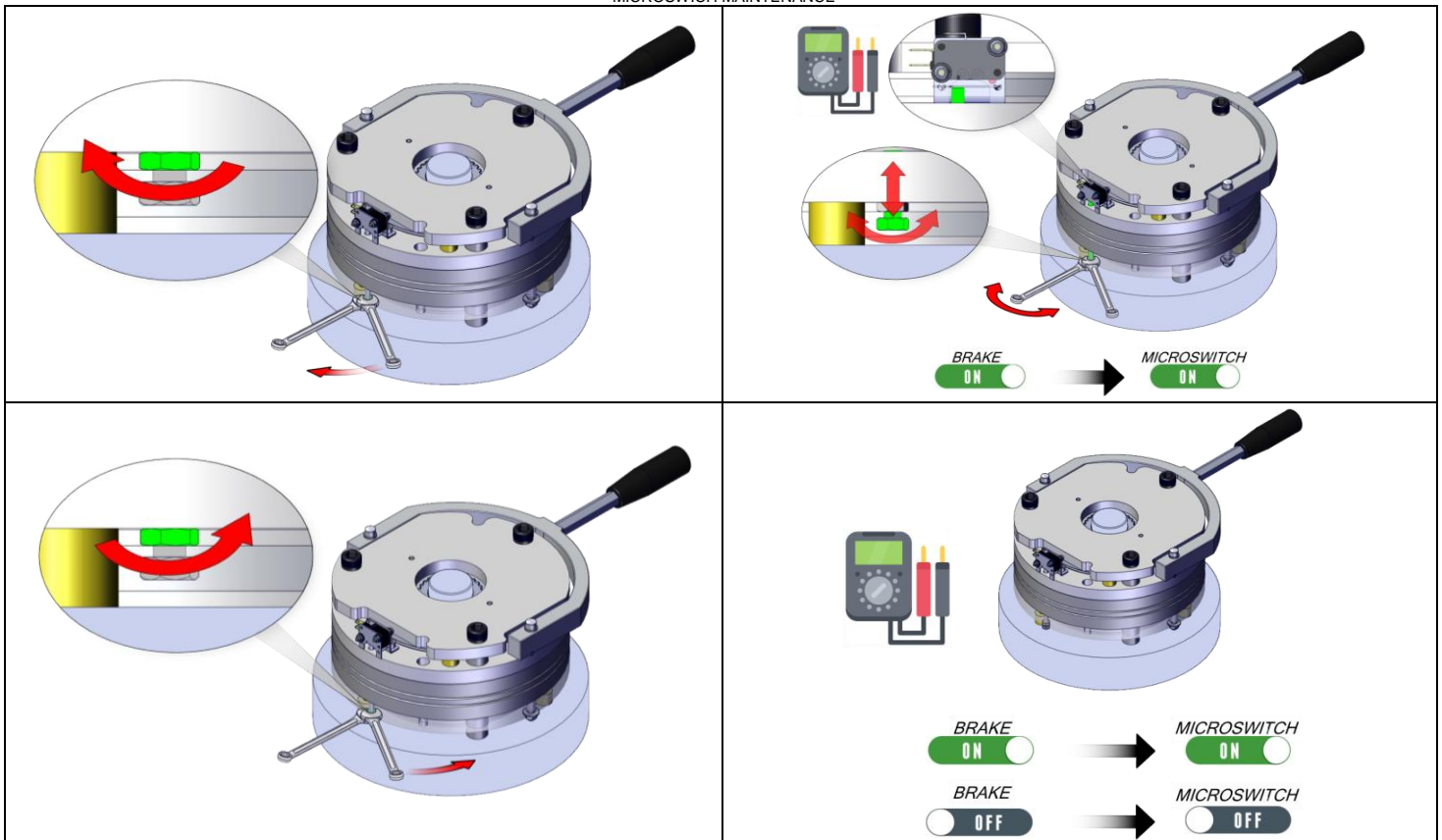

INSPECTION AND MAINTENANCE TIME

<p>INSPECTION THEORETICAL TIME 10min for airgap checking with technician in front of brake</p>	<p>MAINTENANCE THEORETICAL TIME 1h for brake and disc sostitution with technician in front of brake</p>
--	---

RISK HYPOTHESIS

RISK	ACTION TO DO
Shaft/ hub assembly with non-compliant tolerance No signal by microswitch	Adapt to tolerances Contact Temporiti srl

DISPOSAL AND RECYCLE INFORMATION

	<p>RECYCLE IN ECO-FRIENDLY WAY THE PACKAGING, METALS AND ALL THE PARTS OF NO LONGER WORK BRAKES: DO NOT THROW USED ELECTROBRAKES, OR PARTS THEREOF, IN THE HOUSEHOLD RUBBISH!</p>	<p>Dispose separately from household rubbish the friction material (asbestos-free) after removing it from the metal part of the disk with a proper tool. Remove the resin from the electromagnet with a proper tools and dispose of it in accordance with current law regulations. According the European Directive 2002/96/CE on waste electrical and electronic equipments (RAEE) and its implementation of national law, the electrical equipments no longer usable must be collected separately and must be sent to a recycling step.</p>
--	--	---